

# Century Plaza Towers

2049 CENTURY PARK EAST  
LOS ANGELES, CA

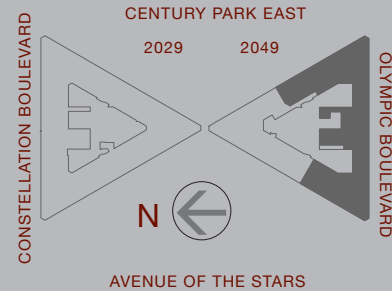

Floor 44S Suite # 4400  
16,588 RSF 13,453 USF



FOR LEASING, CONTACT:  
CBRE  
310.226.7400  
[www.centurypark.net](http://www.centurypark.net)

Distinguished COMPANY

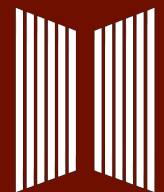

CENTURY PLAZA TOWERS  
AT CENTURY PARK

CENTURY PARK EAST

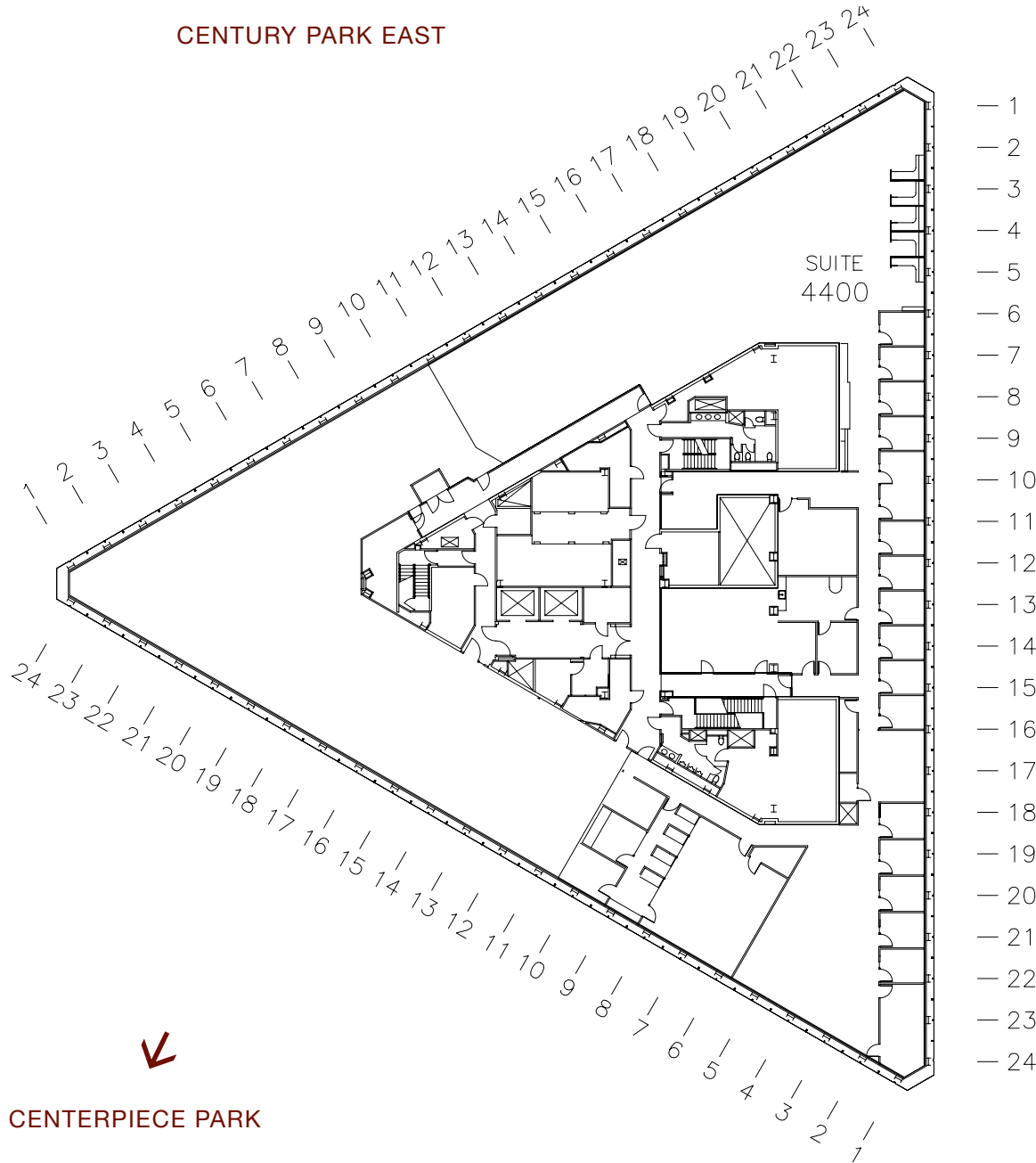

The information has been obtained from sourced believed to be reliable. However, we have not verified it and make no guarantee, warranty, certification or representation about it. Neither CBRE nor ownership shall have any liability whatsoever for any inaccurate or incomplete information contained herein. You and your advisors should conduct a careful, independent investigation and review of the property to determine to your satisfaction the suitability and accuracy of the information contained herein.